

**EMPRESA FUNDADA EN 1977**

**CAÑOS PP MILIMETRICO PN**

**INFORMACION TECNICA**

**PN 12,5**

Cota	De (mm)	e (mm)	L (mm)
20 mm x 4 mts.	20	1.9	4000
25 mm x 4 mts.	25	2.3	4000
32 mm x 4 mts.	32	3.0	4000
40 mm x 4 mts.	40	3.7	4000
50 mm x 4 mts.	50	4.6	4000
63 mm x 4 mts.	63	5.8	4000
75 mm x 4 mts.	75	6.9	4000
90 mm x 4 mts.	90	8.2	4000

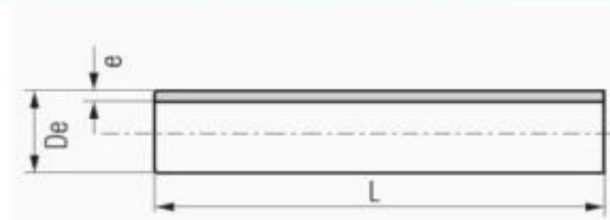



CAÑOS - ACCESORIOS - VALVULAS

Brandsen 2479 C.P. 1702 - José Ingenieros  
Buenos Aires - Argentina  
Teléfono: (54-11) 4757-3204/6004/1618  
FAX Directo: 4712-5754  
Info@canopol.com / www.canopol.com

ISO 9001  
BUREAU VERITAS  
Certification



EMPRESA FUNDADA EN 1977

## CAÑOS PP MILIMETRICO PN

### INFORMACION TECNICA

#### PN 20

Codigo	Cota	De (mm)	e (mm)	L (mm)
131620	20 mm x 4 mts.	20	2.8	4000
131625	25 mm x 4 mts.	25	3.5	4000
131632	32 mm x 4 mts.	32	4.5	4000
131640	40 mm x 4 mts.	40	5.6	4000
131650	50 mm x 4 mts.	50	6.9	4000
131663	63 mm x 4 mts.	63	8.7	4000
131675	75 mm x 4 mts.	75	10.4	4000
131690	90 mm x 4 mts.	90	12.5	4000



**EMPRESA FUNDADA EN 1977**

**CAÑOS PP MILIMETRICO PN**

**INFORMACION TECNICA**

**PN 25**

Codigo	Cota	De (mm)	e (mm)	L (mm)
132020	20 mm x 4 mts.	20	3.4	4000
132025	25 mm x 4 mts.	25	4.2	4000
132032	32 mm x 4 mts.	32	5.4	4000
132040	40 mm x 4 mts.	40	6.7	4000
132050	50 mm x 4 mts.	50	8.4	4000
132063	63 mm x 4 mts.	63	10.5	4000
132075	75 mm x 4 mts.	75	12.5	4000
132090	90 mm x 4 mts.	90	15.0	4000

